



GE CT Scanners

General Cleaning and Disinfection

Quick Reference Guide
Version 1.1



1 General cleaning and disinfection Guidance

- ❖ Careful planning and diligent upkeep of a CT facility can provide a safe environment for both patients and employees.
- ❖ Cleaning and disinfection of patient contact surfaces is recommended following each use of the Scanner, table and associated accessories.
- ❖ All non-patient contact surfaces such as User interface screen and control room equipment should be cleaned and disinfected following internal housekeeping procedures unless otherwise indicated in the following instructions
- ❖ Always inspect pads for peeling or cracking. If a cracked or peeling pad is identified, replace these to prevent potential biohazard contamination
- ❖ **Please always refer to the official operator manual and instructions for use**

Below information is adapted from the maintenance and cleaning section of the system's user manual:

- Keep the equipment clean
- Remove body fluids and/or IV spills to prevent a health risk and damage to internal parts.
- Follow cleaning agent manufacturer instructions. Apply using a non-lint cloth or supplied cleaning agent wipe
- Also, use dry cleaning for electronic components
- Regardless of the method used, **inspect** to ensure visual cleanliness prior to disinfection.
- **Repeat** the cleaning process until all visible dirt has been removed.

Cleaning Equipment (Bio Hazard)



CAUTION: Blood Borne Pathogens Procedure - Before any equipment is serviced or returned to GE Medical Systems, the following criteria must be met:

- Equipment used in a clinical setting must be cleaned and free of any blood and other infectious substances.

2 Cleaning and Disinfection Material Guidance

For information on the cleaning and disinfecting agents, GE Healthcare has created a website that provides an overview of the products that have been tested for compatibility with our device materials (Compatibility testing only, not related to cleaning and disinfection efficacy):

<https://cleaning.gehealthcare.com/>

- Within this site you can use the filters to refine by clinical area, device or cleaning product as well use the contextual search:

To Search: Select One Or More Clinical Area, Device, Cleaning/Disinfecting Products.
OR, Use Text Search To Find The Matches In All Three Lists.
Click [HERE](#) for more details about this website.
Click [HERE](#) to return to the main GE Healthcare COVID-19 page.

Updated: 03-26-2020

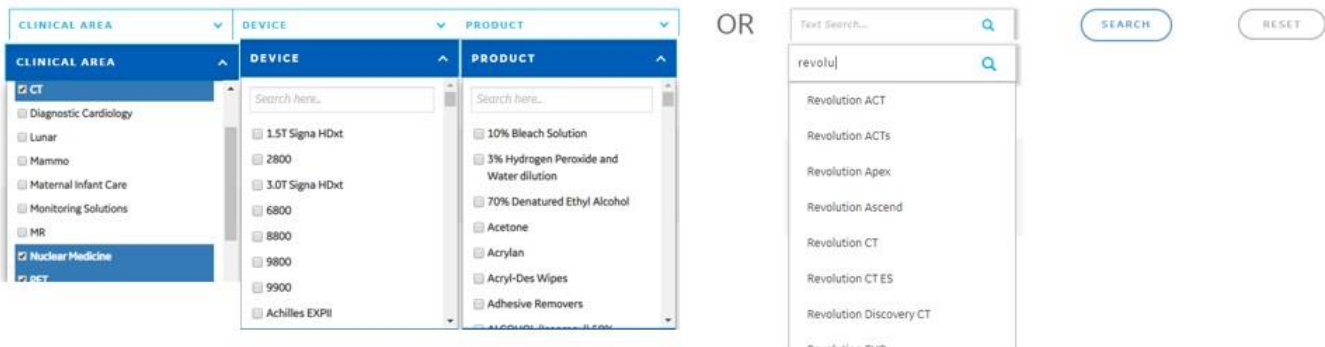

- You can download or print the information. Below you can find the list of compatible agents for all CT systems as per March 26th 2020, we encourage you to visit the site for anydoubt:
 - Under the PRODUCT category below, "*" denotes those that are listed on the United States Environmental Protection Agency (EPA) website (<https://www.epa.gov/pesticide-registration/list-n-disinfectants-use-against-sars-cov-2>) as a disinfectant for use against SARS-CoV-2, the cause of COVID-19.

Below mentioned disinfectants are recommended by GE Healthcare and are easily available in India-South Asia region:

- Lizol Surface Cleaner
- Clorox Healthcare Bleach Germicidal Wipes
- Cleanisept Wipes
- Bacillol – 25
- D-125 Disinfectant
- 10%/90% Home Bleach Solution (Sodium hypochlorite)

3 Disinfection following exposure to Bio Hazard

For infected patients, the equipment should be cleaned using high-level disinfecting agents as mentioned in section 2. The suggested equipment clean- up procedure for cleaning any fluids or matter discovered in accessible areas or inside under direction of service are as follows:

- Wear personal protective equipment.
- Wear proper Nitrile gloves.
- Before cleanup, take note of sharp corners or objects that could cut the gloves. If gloves tear, remove, wash hands thoroughly, and re-glove.
- Use cloth or paper towels along with cleaner, taking care not to splash.
- Sanitize the area using common bleach diluted 10:1 or an approved cleaning agent listed in the Maintenance and Cleaning section.
- For general disinfection or disinfection following cleaning of blood and/or body fluids, 5 minutes contact time is recommended. Refer to internal procedures or refer to publications such as “CDC Guideline for Disinfection and Sterilization in Healthcare Facilities,” 2008 or latest revision, for guidance.
- Disinfectant may need to be re-applied to ensure surfaces remain wet for the duration of the selected contact time
- After you have cleaned and disinfected with bleach (sodium hypochlorite) wipe surfaces with a disposable lint free wipe that has been dampened with purified water to remove any remaining bleach residue.
- Clean any tools that come in contact with body fluid.
- Since viruses require moisture to remain active, dry the entire area.
- When confident the area is clean and dry, place cleaning materials in a red biohazard bag

As per IRIA ICRI Imaging guidance, below steps are to be followed after CT scan

- After leaving the CT suite, the high-frequency contact surfaces (i.e., operating consoles, switches, handles, and doorknobs) are wiped with a cloth soaked with alcohol-based disinfectants. Follow the following steps:
 - 3 big buckets for floor
 - 3 small buckets for machine
 - 1st bucket has water
 - 2nd has detergent water
 - 3rd has FRESHLY prepared bleach or 1% sodium hypochlorite
 - 1st clean machine with mop/cotton swab and detergent water (2nd small bucket) -dip in water(1st small bucket)-wring excess-then dip in 1% sodium hypochlorite solution(3rd small bucket)-wring excess fluidwipe down
- The CT suite is tightly closed for 1 h to thoroughly ventilate and exchange the room air
- The cleaning cloth/wipe soaked in disinfectant solution should be just wet and not dripping with liquid so that the liquid doesn't seep into the CT system

As per Ministry of Health & Family Welfare`s SOP for Equipment Cleaning & Disinfection & Preparation of 1% Sodium Hypochlorite Solution

<https://www.mohfw.gov.in/pdf/StandardOperatingProcedureSOPfortransportingasuspectorconfirmedcaseofCOVID19.pdf>

- Equipment and surfaces are contaminated if they have come in contact with patient's skin, blood or body fluids. These can spread infection. Therefore, it is mandatory that these are cleaned and disinfected using 1% sodium hypochlorite or alcohol based disinfectants at least once daily and after every patient contact.
- Patient care items and surfaces that can contribute to the spread of infection include:

- Stethoscopes
- Blood pressure cuffs
- Monitors
- Stretchers, backboards, and immobilization devices
- Laryngoscope blades
- Radios/mobiles
- Shelves
- Door handles
- Other items and surfaces in ambulance or transport vehicle

4 External references and useful resources

- Annexure Guidelines for Preparation of 1% sodium hypochlorite solution

Product	Available Chlorine	1 Percent
Sodium hypochlorite – liquid bleach	3.50%	1-part bleach to 2.5 parts water
Sodium hypochlorite – liquid	5%	1-part bleach to 4 parts water
NaDCC (sodium dichloroisocyanurate) powder	60%	17 grams to 1 litre water
NaDCC (1.5 g/ tablet) – tablets	60%	11 tablets to 1 litre water
Chloramine – powder	25%	80 g to 1 litre water
Bleaching powder	70%	7g g to 1 litre water
Any other	As per manufacturer’s Instructions	

- ICMR – Hospital infection guidelines – Cleaning, Disinfection & Sterilization
https://www.icmr.nic.in/sites/default/files/guidelines/Hospital_Infection_control_guidelines.pdf
- CDC Guideline for Disinfection and Sterilization in Healthcare Facilities, 2008 Update May 2019
<https://www.cdc.gov/infectioncontrol/pdf/guidelines/disinfection-guidelines-H.pdf>
- IRIA ICRI Guidelines
<https://iria.org.in/covid-19-imaging-recommendations-2/>
- For Covid-19:
 - ECDC Infection prevention and control for COVID-19 in healthcare settings (March 2020):
<https://www.ecdc.europa.eu/en/publications-data/infection-prevention-and-control-covid-19-healthcare-settings>
 - <https://www.epa.gov/pesticide-registration/list-n-disinfectants-use-against-sars-cov-2>
 - ECDC preparedness for COVID-19: <https://www.ecdc.europa.eu/en/all-topics-z/coronavirus/threats-and-outbreaks/covid-19/preparedness-and-response-covid-19>

www.gehealthcare.com

GE Healthcare provides transformational medical technologies and services that are shaping a new age of patient care. Our broad expertise in medical imaging and information technologies, medical diagnostics, patient monitoring systems, drug discovery, biopharmaceutical manufacturing technologies, performance improvement and performance solutions services help our customers to deliver better care to more people around the world at a lower cost.

In addition, we partner with healthcare leaders, striving to leverage the global policy change necessary to implement a successful shift to sustainable healthcare systems.

imagination at work

©2020 General Electric Company All rights reserved. General Electric Company reserves the right to make changes in specifications and features shown herein, or discontinue the product or service described at any time, without notice or obligation.

The materials contained in this course/document are intended for educational purposes only.

This course/document does not establish specifications, operating procedures, or maintenance methods for any of the products referenced. Always refer to the official written materials (labeling) provided with the product for specifications, operating procedures, and maintenance requirements. Configurations available for any product mentioned, will depend on local market and standards requirements. Illustrations in this course/document may not represent all configurations of the product. This course/document does not cover the operation of every accessory.

Proprietary Training Material Property of GE Healthcare.

No diagnostic statements are inferred or included in these materials. All clinical diagnosis should be made by a trained physician or clinician. All patient names or other protected health information or data contained in any image within this material is fictitious. Any similarity to actual persons is coincidental.