



**GE Healthcare
Project Management**

GE Healthcare has made reasonable efforts to ensure this BIM file conforms to requirements of the applicable pre-installation manual. This BIM file was produced to assist with site planning and is not intended for construction or final building modeling. GE Healthcare is not responsible for any damages resulting from use of such file for construction or final building modeling purposes. Compliance with all applicable local, state, and federal laws and regulations is the responsibility of the customer or its designated architects and engineers. Please keep in mind the information in this BIM file is dynamic and is subject to change without notice. It is the responsibility of the customer or its designated architect(s) and engineer(s) to ensure they have the latest equipment or product information.

**OPTIMA PET/CT 560/560FX DISCOVERY PET/CT
610/710 - RENDERING**

| | |
|-----------------------|-------------------|
| Project number | 12-26 |
| Date | 07.JULY.17 |
| Drawn by | GENPACT |
| Checked by | |

A-1

Scale 12" = 1'-0"

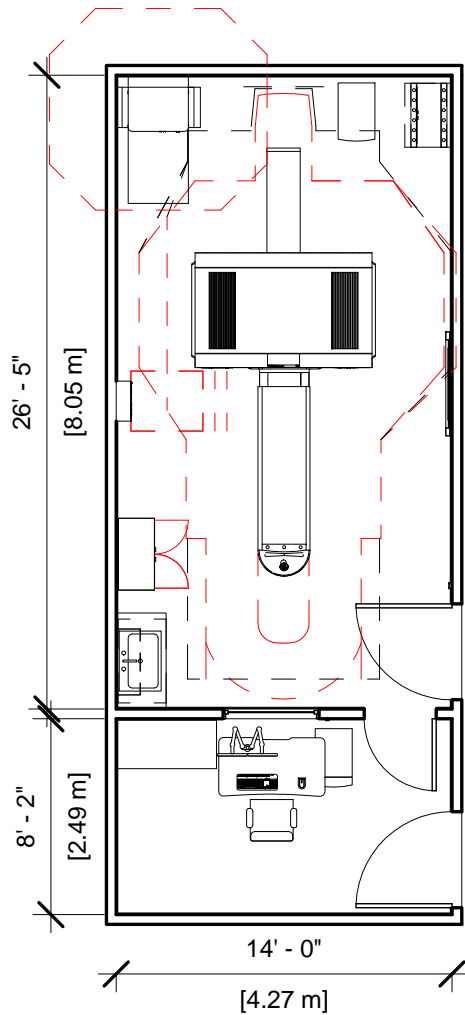

Specialty Equipment Schedule

| Description | Weight (lbs) | BTU |
|---|--------------|-------|
| CONTROL ROOM | | |
| LARGE TABLE OPERATOR'S CONSOLE | 341 | 8191 |
| EXAM ROOM | | |
| STORAGE CABINET | 99 | 0 |
| OPTIMA PET/CT 560/560FX DISCOVERY PET/CT 610/710 | 8529 | 36669 |
| POWER DISTRIBUTION UNIT | 800 | 3399 |
| UPS | 619 | 5122 |
| MAIN DISCONNECT CONTROL | 90 | 0 |
| QCORE | 191 | 1498 |
| PATIENT TABLE (WITHOUT PATIENT) | 1803 | 1023 |



**GE Healthcare
Project Management**

GE Healthcare has made reasonable efforts to ensure this BIM file conforms to requirements of the applicable pre-installation manual. This BIM file was produced to assist with site planning and is not intended for construction or final building modeling. GE Healthcare is not responsible for any damages resulting from use of such file for construction or final building modeling purposes. Compliance with all applicable local, state, and federal laws and regulations is the responsibility of the customer or its designated architects and engineers. Please keep in mind the information in this BIM file is dynamic and is subject to change without notice. It is the responsibility of the customer or its designated architect(s) and engineer(s) to ensure they have the latest equipment or product information.

**OPTIMA PET/CT 560/560FX DISCOVERY PET/CT
610/710 PLAN & SCHEDULE**

Project number 12-26

Date 07.JULY.17

Drawn by GENPACT

Checked by

A-2

Scale 1/8" = 1'-0"

Hold the Left Click for Rotating around
Use the Scroll for Zooming in and out



12-26 - Optima PET-CT 560FX



GE Healthcare

[Click for Site Planning Support](#)