



**GE Healthcare
Project Management**

GE Healthcare has made reasonable efforts to ensure this BIM file conforms to requirements of the applicable pre-installation manual. This BIM file was produced to assist with site planning and is not intended for construction or final building modeling. GE Healthcare is not responsible for any damages resulting from use of such file for construction or final building modeling purposes. Compliance with all applicable local, state, and federal laws and regulations is the responsibility of the customer or its designated architects and engineers. Please keep in mind the information in this BIM file is dynamic and is subject to change without notice. It is the responsibility of the customer or its designated architect(s) and engineer(s) to ensure they have the latest equipment or product information.

OPTIMA MR360 - RENDERING

Project number	8-238
Date	5.APRIL.17
Drawn by	GENPACT
Checked by	

A-1

Scale 12" = 1'-0"

Specialty Equipment Schedule

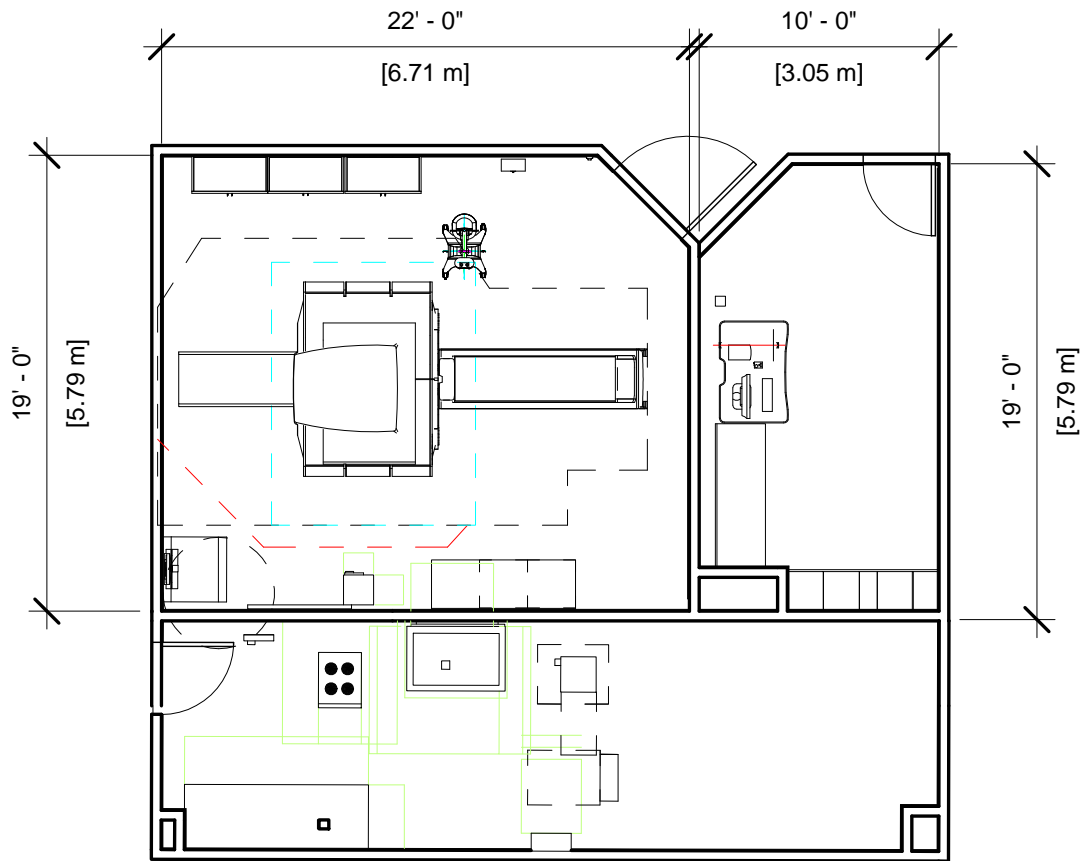

Description	Weight (lbs)	BTU
-------------	--------------	-----

BLOWER BOX	46	3412
COOLING UNIT	220	19617
DC LIGHTING CONTROL PANEL	155	1024
DC LIGHTING TRANSFORMER	60	171
MAGNET RUNDOWN UNIT	8	0
MAGNET MONITOR	22	204
MAIN DISCONNECT CONTROL	350	900
MESH SHIELD	0	0
SYSTEMS CABINET	1962	17064
SHIELD COOLER CABINET F50	264	1706
SPT PHANTOM STORAGE CABINET	350	0
AIR CONDITIONING	0	0
3.0 TESLA ACTIVE SHIELD MAGNET (and table)	17100	8191
1.5 TESLA ACTIVE SHIELD MAGNET	13115	8191
REAR PEDESTAL	212	0
3.0 TESLA ACTIVE SHIELD MAGNET (and table)	279	0
ROOM SUPPLY CABINET	0	0
ROOM SUPPLY CABINET	0	0
ROOM SUPPLY CABINET	0	0

CONTROL ROOM

WORKSTATION TABLE	0	0
OPERATOR WORKSPACE CABINET	198	0
OPERATOR WORKSPACE WITH COLOR LCD MONITOR	85	4948
REMOTE CONTROL PANEL FOR 11KW CHILLER	0	0



GE Healthcare
Project Management

GE Healthcare has made reasonable efforts to ensure this BIM file conforms to requirements of the applicable pre-installation manual. This BIM file was produced to assist with site planning and is not intended for construction or final building modeling. GE Healthcare is not responsible for any damages resulting from use of such file for construction or final building modeling purposes. Compliance with all applicable local, state, and federal laws and regulations is the responsibility of the customer or its designated architects and engineers. Please keep in mind the information in this BIM file is dynamic and is subject to change without notice. It is the responsibility of the customer or its designated architect(s) and engineer(s) to ensure they have the latest equipment or product information.

OPTIMA MR360 FLOOR PLAN

Project number	8-238	A-2
Date	5.APRIL.17	
Drawn by	GENPACT	
Checked by		

Scale 1/8" = 1'-0"

Hold the Left Click for Rotating around
Use the Scroll for Zooming in and out



8-238 - Optima MR 360 Advance - Brivo MR Inspire



GE Healthcare

[Click for Site Planning Support](#)