



**GE Healthcare
Project Management**

GE Healthcare has made reasonable efforts to ensure this BIM file conforms to requirements of the applicable pre-installation manual. This BIM file was produced to assist with site planning and is not intended for construction or final building modeling. GE Healthcare is not responsible for any damages resulting from use of such file for construction or final building modeling purposes. Compliance with all applicable local, state, and federal laws and regulations is the responsibility of the customer or its designated architects and engineers. Please keep in mind the information in this BIM file is dynamic and is subject to change without notice. It is the responsibility of the customer or its designated architect(s) and engineer(s) to ensure they have the latest equipment or product information.

VENTRI (ADVANCED) - RENDERING

Project number	7-86
Date	19.JULY.17
Drawn by	GENPACT
Checked by	

A-1

Scale 12" = 1'-0"

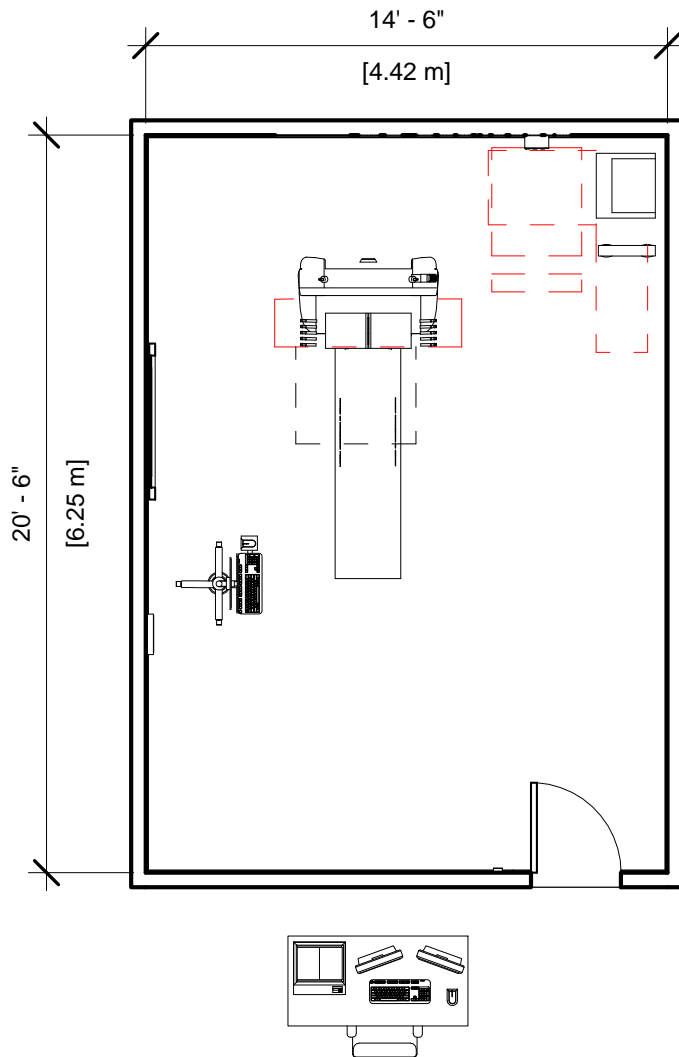

Specialty Equipment Schedule

Description	Weight (lbs)	BTU
XELERIS WORKSTATION	55	255
TABLE	0	0
COLOR PRINTER	0	1054
EXAM ROOM		
UPS SYSTEM	33	4436
VENTRI GANTRY	1432	2904
COLLIMATOR CABINET	88	0
MAIN DISCONNECT, REFERENCE JUNCTION POINT 'A' ON SHEET E1 FOR DETAILED DESCRIPTION.	0	0
MAIN DISCONNECT, REFERENCE JUNCTION POINT 'A' ON SHEET E1 FOR DETAILED DESCRIPTION.		
MAIN DISCONNECT, REFERENCE JUNCTION POINT 'A' ON SHEET E1 FOR DETAILED DESCRIPTION.		
MAIN DISCONNECT, REFERENCE JUNCTION POINT 'A' ON SHEET E1 FOR DETAILED DESCRIPTION.		
MAIN DISSCONNECT, REFERENCE		
VENTRI TABLE (ADVANCED TABLE)	705	2047
INTEGRATED POWER SUPPLY	171	341
OPERAORS CONSOLE		



**GE Healthcare
Project Management**

GE Healthcare has made reasonable efforts to ensure this BIM file conforms to requirements of the applicable pre-installation manual. This BIM file was produced to assist with site planning and is not intended for construction or final building modeling. GE Healthcare is not responsible for any damages resulting from use of such file for construction or final building modeling purposes. Compliance with all applicable local, state, and federal laws and regulations is the responsibility of the customer or its designated architects and engineers. Please keep in mind the information in this BIM file is dynamic and is subject to change without notice. It is the responsibility of the customer or its designated architect(s) and engineer(s) to ensure they have the latest equipment or product information.

VENTRI (ADVANCED) - PLAN & SCHEDULE

Project number	7-86
Date	19.JULY.17
Drawn by	GENPACT
Checked by	

A-2

Scale 3/16" = 1'-0"

Hold the Left Click for Rotating around
Use the Scroll for Zooming in and out



7-86 - Ventri w Advanced Table



GE Healthcare

[Click for Site Planning Support](#)