



**GE Healthcare  
Project Management**

GE Healthcare has made reasonable efforts to ensure this BIM file conforms to requirements of the applicable pre-installation manual. This BIM file was produced to assist with site planning and is not intended for construction or final building modeling. GE Healthcare is not responsible for any damages resulting from use of such file for construction or final building modeling purposes. Compliance with all applicable local, state, and federal laws and regulations is the responsibility of the customer or its designated architects and engineers. Please keep in mind the information in this BIM file is dynamic and is subject to change without notice. It is the responsibility of the customer or its designated architect(s) and engineer(s) to ensure they have the latest equipment or product information.

**INNOVA 2121/ 3131 BIPLANE - RENDERING**

<b>Project number</b>	<b>5-84</b>
<b>Date</b>	<b>13.FEB.17</b>
<b>Drawn by</b>	<b>GENPACT</b>
<b>Checked by</b>	

**A-1**

**Scale 12" = 1'-0"**

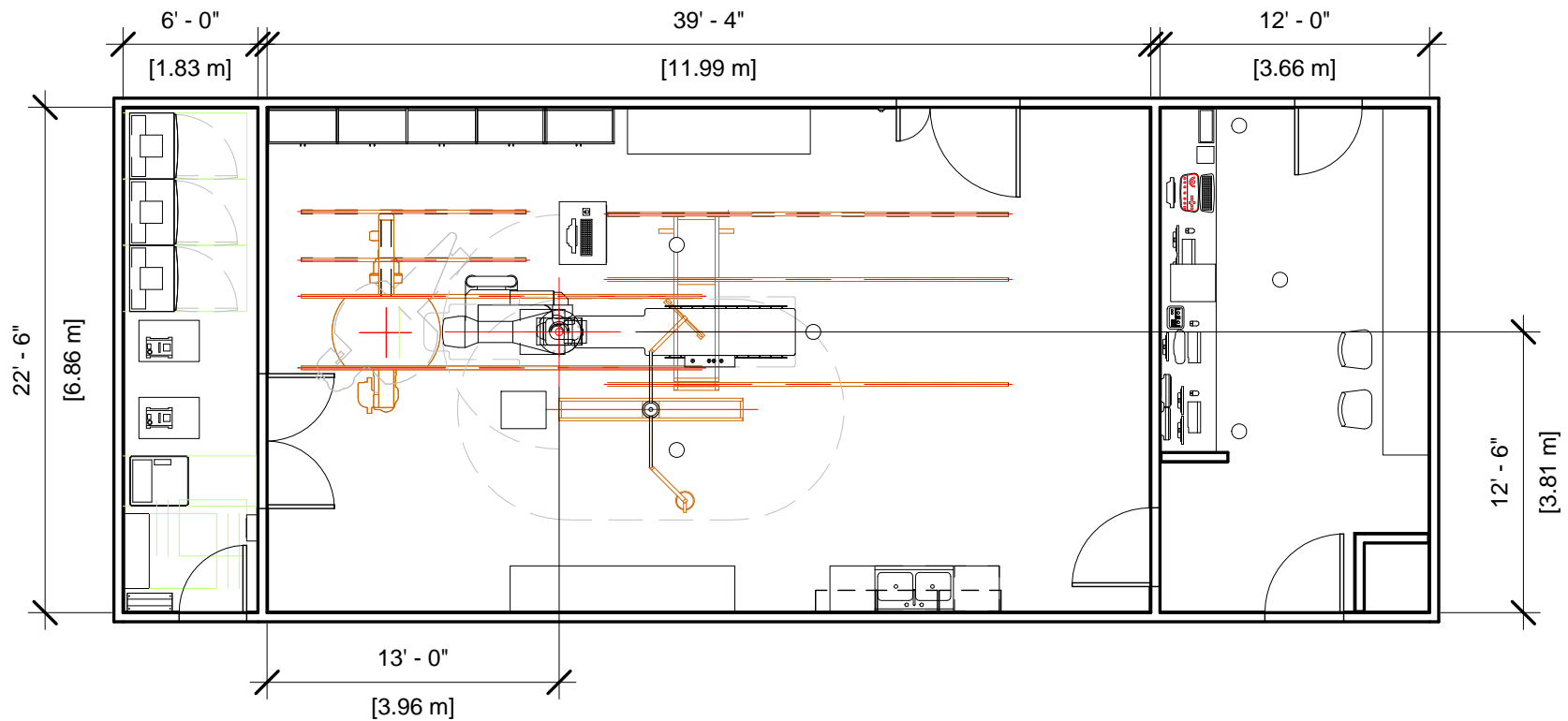

**GE Healthcare  
Project Management**

GE Healthcare has made reasonable efforts to ensure this BIM file conforms to requirements of the applicable pre-installation manual. This BIM file was produced to assist with site planning and is not intended for construction or final building modeling. GE Healthcare is not responsible for any damages resulting from use of such file for construction or final building modeling purposes. Compliance with all applicable local, state, and federal laws and regulations is the responsibility of the customer or its designated architects and engineers. Please keep in mind the information in this BIM file is dynamic and is subject to change without notice. It is the responsibility of the customer or its designated architect(s) and engineer(s) to ensure they have the latest equipment or product information.

**INNOVA 2121/ 3131 BIPLANE FLOOR PLAN**

<b>Project number</b>	5-84
<b>Date</b>	13.FEB.17
<b>Drawn by</b>	GENPACT
<b>Checked by</b>	

**A-2**

**Scale 1/8" = 1'-0"**

### Specialty Equipment Schedule

Description	Weight (lbs)	BTU
<b>CONTROL ROOM</b>		
AW WORKSTATION	81	1201
OPERATORS CONSOLE	22	546
TWO STACKED 18" MONITORS ON WALL SUPPORT	26	204
TWO STACKED 18" MONITORS ON WALL SUPPORT	26	204
VITALINQ SPEAKER	0	0
VITALINQ SPEAKER	0	0
VITALINQ SPEAKER	0	0
VATALINQ MICROPHONE	0	0
VATALINQ CONSOLE	0	0
MAC LAB	181	2935
IVUS VOLCANO S5i CONSOLE	68	1631
COLOR PRINTER	0	1054
REMOTE CONTROL FOR INJECTOR	4	0
<b>EQUIPMENT ROOM</b>		
LATERAL WATER CHILLER	447	16320
AP DETECTOR CHILLER	33	709
3 KVA UPS CABINET	81	546
LATERAL WATER CHILLER	447	16320
UPS CABINET	1170	4050
AP FRONTAL CABINET (C1)	890	4413
LC/LP CABINET (C2)	630	4570
LATERAL CABINET (C3)	705	2945
INNOVA MAIN DISCONNECT	899	2215
AP TUBE CHILLER	447	18723
150-AMP DISCONNECT BREAKER LOTO	0	0

### Specialty Equipment Schedule

Description	Weight (lbs)	BTU
<b>EXAM ROOM</b>		
ROOM SUPPLY CABINET	0	0
ROOM SUPPLY CABINET	0	0
ROOM SUPPLY CABINET	0	0
ROOM SUPPLY CABINET	0	0
LATERAL POSITIONER	1679	4126
LCD MONITOR SUSPENSION	630	1639
COUNTERBALANCED EYE AND THYROID SHIELD WITH LAMP	143	0
INNOVA POSITIONER	1653	2416
OMEGA IV/V TABLE WITH ROTATING TOP	1750	600
VITALINQ SPEAKER	0	0
VITALINQ SPEAKER	0	0
VITALINQ SPEAKER	0	0
VATALINQ MICROPHONE	0	0
NURSE WORSTATION	0	0
ROOM SUPPLY CABINET	0	0



**GE Healthcare  
Project Management**

GE Healthcare has made reasonable efforts to ensure this BIM file conforms to requirements of the applicable pre-installation manual. This BIM file was produced to assist with site planning and is not intended for construction or final building modeling. GE Healthcare is not responsible for any damages resulting from use of such file for construction or final building modeling purposes. Compliance with all applicable local, state, and federal laws and regulations is the responsibility of the customer or its designated architects and engineers. Please keep in mind the information in this BIM file is dynamic and is subject to change without notice. It is the responsibility of the customer or its designated architect(s) and engineer(s) to ensure they have the latest equipment or product information.

#### INNOVA 2121/ 3131 BIPLAN-SCHEDULE

<b>Project number</b>	<b>5-84</b>
<b>Date</b>	<b>13.FEB.17</b>
<b>Drawn by</b>	<b>GENPACT</b>
<b>Checked by</b>	

**A-3**

**Scale**

Hold the Left Click for Rotating around  
Use the Scroll for Zooming in and out



5-84 - Bi-Plane Innova 2121-3131



GE Healthcare

[Click for Site Planning Support](#)